

NOVOTEL AMSTERDAM CITY



**WELCOME TO NOVOTEL
AMSTERDAM CITY**

Novotel Amsterdam City is a perfect hotel if you are seeking a modern, comfortable 4 star hotel offering plenty of facilities. The hotel is ideally located; easy to reach by both private or public transport, as well as being close to Schiphol Airport and the city centre. Novotel Amsterdam City is unique in Amsterdam; 610 hotel rooms are complemented by no less than 18 meeting rooms with 5 meter high ceilings offering plenty of natural daylight.



**LIVE IN YOUR OWN
SPECIAL WORLD AT NOVOTEL**

Enjoy sleek comfort and spaciousness in a stylish room designed to meet all your needs. A premium bed and special touches that make the difference. Relax, get some work done, and take full advantage of your stay.



ENTERTAIN YOUR PALATE AT NOVOTEL

Discover the thrilling simplicity of flavourful contemporary cuisine. Inventive yet well-balanced dishes for delightful meals to enjoy at the hotel restaurant, the terrace or in the privacy of your room.

ACCESS & TRAVEL INFORMATION



- **By train** : Amsterdam RAI station
- **By plane** : Schiphol Airport
- **By car** : From The Hague/Schiphol (A4): go to the A10, take exit S109 and turn left. Novotel is on your right side.
From Amersfoort (A1): Go to the A10, take exit 109 and turn left. Novotel is on your right side.
- **Currency** : EURO

GROUND FLOOR

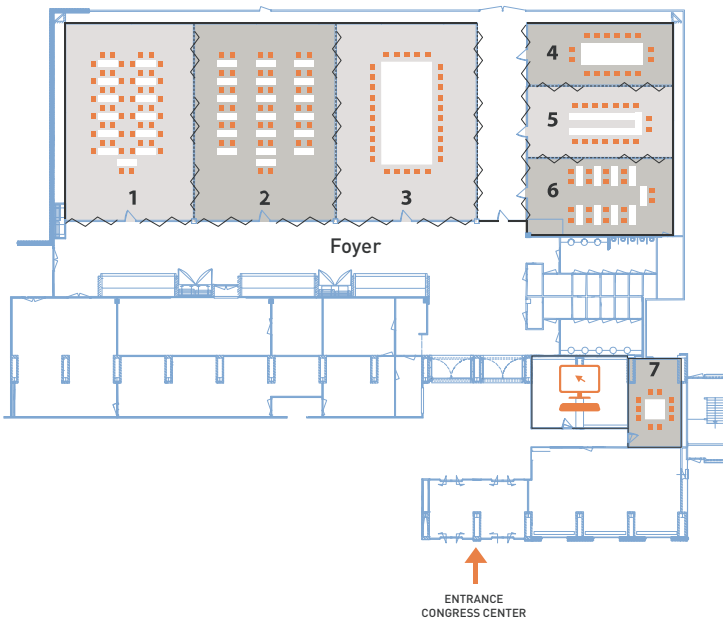

FIRST FLOOR

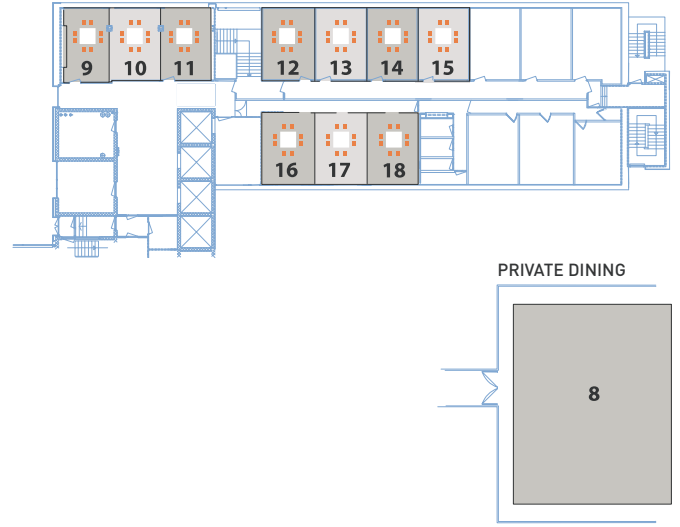

BUSINESS FACILITIES

- 1.000 m2 conference center with separate entrance
- Up to a maximum of 1000 people for a (cocktail) reception
- Featuring individual airconditioning and Bose sound system
- High ceilings meeting spaces (4 and 5 meters)
- All meeting rooms have natural daylight
- Spacious meeting foyer & business corner
- 18 meeting rooms in total of which 11 boardrooms
- Professional video conferencing room up to 8 persons
- Possibility for meet, eat and sleep all under one roof up to 450 persons
- Tailor made meeting packages



This hotel is a participating contributor to the global Plant for the Planet tree-planting scheme. Over the past 6 years, by reusing the towels in your room, you have helped us to have over 4 million trees planted worldwide.

	AREA (M ²)	LENGHT (M)	WIDTH (M)	HEIGHT (M)	THEATRE	U-SHAPE	BOARD ROOM	CLASS ROOM	CABARET	CABARET ROUNDS OF 8	DINNER	RECEPTION	DAY-LIGHT
CONGRESS CENTRE - GROUND FLOOR													
1 Calla*	176	16	11	5	170	38	-	96	92	88	110	200	✓
2 Calla*	176	16	11	5	170	38	-	96	92	88	110	200	✓
3 Calla*	176	16	11	5	170	38	-	96	92	88	110	200	✓
4 Rosa	66	11,8	5,6	4	54	20	16	24	27	16	30	40	✓
5 Rosa	66	11,8	5,6	4	54	20	16	24	30	18	30	40	✓
6 Rosa	66	11,8	5,6	4	54	20	16	24	30	18	30	40	✓
7 Orchis**	28	7,1	4	3,4	-	-	10	-	-	-	-	-	✓
8 Magnolia***	185	13,6	13,6	2,5	60	25	-	40	45	60	100	120	-
CONGRESS CENTRE - FIRST FLOOR													
9 Anemone	20	5,6	3,6	2,6	-	-	9	-	-	-	-	-	✓
10 Bellis	20	5,6	3,6	2,6	-	-	9	-	-	-	-	-	✓
11 Calendula	20	5,6	3,6	2,6	-	-	9	-	-	-	-	-	✓
12 Euphorbia	20	5,6	3,6	2,6	-	-	9	-	-	-	-	-	✓
13 Galanthus	20	5,6	3,6	2,6	-	-	9	-	-	-	-	-	✓
14 Lilium	20	5,6	3,6	2,6	-	-	9	-	-	-	-	-	✓
15 Malva	20	5,6	3,6	2,6	16	-	9	-	-	-	-	-	✓
16 Parnassia	20	5,6	3,6	2,6	-	-	9	-	-	-	-	-	✓
17 Scilla	20	5,6	3,6	2,6	-	-	9	-	-	-	-	-	✓
18 Tulipa	20	5,6	3,6	2,6	-	-	9	-	-	-	-	-	✓
COMBINATIONS													
Calla 1+2*	352	16	22	5	350	54	-	192	184	176	220	400	✓
Calla 2+3*	352	16	22	5	350	54	-	192	184	176	220	400	✓
Calla 1+2+3*	528	16	33	5	525	68	-	288	276	264	330	600	✓
Rosa 4+5	132	11,8	11,2	4	110	26	-	54	57	56	90	120	✓
Rosa 5+6	132	11,8	11,2	4	110	26	-	60	57	56	90	120	✓
Rosa 4+5+6	198	11,8	16,8	4	160	34	-	68	87	80	140	200	✓
Calla 1-3 + Rosa 4-6*	1000	50	20	4&5	-	-	-	375	352	384	500	1000	✓

Capacity of the meeting rooms in number of guests

*includes space for a stage of 6 x 2 meters **Luxury boardroom ***private dining

