



NH COLLECTION

GRAND HOTEL KRASNAPOLSKY

Location

The hotel is located in the heart of Amsterdam's characteristic historical centre with a view of the Royal Palace. Trendsetting shopping streets are around the corner, as well as museums like Anne Frank House and the Rijksmuseum. Amsterdam Central Station is at seven minutes walking distance, and bus and tram stops are just around the corner.

Station Amsterdam Central **0,7 km**

Airport Schiphol **15 km**

Bus stop **0,1 km**



own parking



free wi-fi



accessible



celebrations



gym



meetings



pets allowed



babysitter



451 Rooms

- 17 Superior Individual Rooms
- 124 Superior Rooms
- 6 Superior Rooms with view
- 194 Premium Rooms
- 6 Premium Rooms XL
- 16 Premium Rooms with view
- 6 Premium Rooms XL with view
- 9 Premium Rooms with view and terrace
- 10 Premium Triple Rooms
- 8 Family Rooms
- 6 Suites
- 12 Suites with view
- 1 Royal Suite
- 1 Presidential Suite
- 35 Apartments

Hotel facilities

- Dry cleaning service
- Ironing and laundry service
- Indoor parking (paid)
- Valet parking (daytime)
- Free newspaper
- Fitness
- Bicycle rental
- Facilities for the disabled
- Concierge services

Room facilities

- Recently renovated rooms
- Mattresses exclusively designed for NH Collection
- Choice of pillows
- Individually-controlled air conditioning
- 24/7 in-room dining
- Free wireless internet access
- Nespresso coffee machines
- Mini bar
- Exclusive amenity line
- Professional hairdryer
- International power adapters

Food & drinks

- Grand Café Krasnapolsky
- Sumptuous breakfast buffet in iconic monumental Winter Garden
- The Tailor bar
- 'Early bird' breakfast

Meetings & events

- 17 meeting rooms
- Capacity for up to 2,000 people
- Monumental Winter Garden
- State of the art AV facilities
- Special banqueting menu by 3* Michelin chef Jacob Jan Boerma

Specially adapted rooms are available for disabled guests.



NH COLLECTION

GRAND HOTEL KRASNAPOLSKY

Function rooms and their capacities



GROUND FLOOR

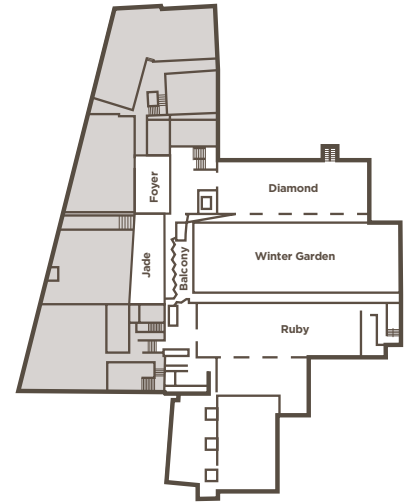

FIRST FLOOR

MEETING ROOM NAME	AREA		square	u-shape	theatre	cabaret	classroom	cocktail	dinner	DAYLIGHT
	M ²	FEET								
Grand Ballroom	510	5490	50	90	700	265	346	600	320	-
The Winter Garden	462	4973	-	-	-	-	-	600	320	Yes
The Winter Garden + Emerald Rooms	677	7288	-	-	-	-	-	750	490	Yes
The Winter Garden + Grand Ballroom +	1187	12778	-	-	-	-	-	1500	840	Yes
Opal I	131	1475	20	30	160	48	60	100	80	Yes
Opal II	181	2035	30	42	240	80	110	150	120	Yes
Opal I + II	312	3499	50	84	440	120	200	275	220	Yes
Emerald I	71	765	18	24	81	32	27	60	50	Yes
Emerald II	71	765	18	24	81	32	27	60	50	Yes
Emerald III	71	765	18	24	81	32	27	60	50	Yes
Emerald I + II / II + III	142	1539	24	48	179	64	63	125	110	Yes
Emerald I + II + III	215	2315	32	66	277	96	150	225	170	Yes
Board Rooms I, II, III	13,5	151	8	-	-	-	-	-	8	Yes
Amber I	125	1345	46	41	117	48	54	90	70	Yes
Amber II	41	441	22	17	48	16	24	30	20	Yes
Topaz	90	969	20	20	54	30	24	60	50	Yes
Diamond	230	2548	40	90	333	128	150	225	170	Yes
Ruby	210	2261	40	66	252	120	90	175	120	Yes
Jade + Balcony	-	-	-	-	-	-	-	50	-	Yes

Capacities are based on the maximum numbers with the use of narrow seats.